



**DESIGN AND CONSTRUCTION GROUP  
THE GOVERNOR NELSON A. ROCKEFELLER  
EMPIRE STATE PLAZA  
ALBANY, NY 12242**

---

**ADDENDUM NO. 1 TO PROJECT NO. 44902**

**CONSTRUCTION WORK  
REPLACE PERIMETER SIDEWALKS  
KINGSBORO PSYCHIATRIC CENTER  
681 CLARKSON AVENUE  
BROOKLYN, NY**

March 9, 2016

**NOTE:** This Addendum forms a part of the Contract Documents. Insert it in the Project Manual. Acknowledge receipt of this Addendum in the space provided on the Bid Form.

**CONSTRUCTION SPECIFICATIONS:**

1. Section 014100 -C – Regulatory Requirements page 3 subparagraph 1.03 B.1.: Add the following subparagraph.
  - a. h. Employ a certified arborist who has functioned with NYC Parks Department to provide a survey of trees affected by the work of this contract. Survey to include tree locations, species, and diameter per NYC Forestry Application & Tree Survey.

**CONSTRUCTION DRAWINGS:**

2. Revised Drawings:
  - a. Drawing C-119 noted “Revised Drawing Dated 3/9/16” accompanies this Addendum and supersedes the same numbered originally issued drawing.

**END OF ADDENDUM**

Margaret F. Larkin  
Executive Director  
Design and Construction

CONSULTANT

LEGEND



WARNING:  
THE ALTERATION OF THIS MATERIAL IN ANY WAY, UNLESS DONE UNDER THE DIRECTION OF A COMPARABLE PROFESSIONAL, I.E. ARCHITECT FOR AN ARCHITECT, ENGINEER FOR AN ENGINEER OR LANDSCAPE ARCHITECT FOR A LANDSCAPE ARCHITECT, IS A VIOLATION OF THE NEW YORK STATE EDUCATION LAW AND/OR REGULATIONS AND IS A CLASS 'A' MISDEMEANOR.



CONSTRUCTION

TITLE: REPLACE PERIMETER SIDEWALKS

LOCATION: KINGSBORO PSYCHIATRIC CENTER  
681 CLARKSON AVENUE  
BROOKLYN, NEW YORK

CLIENT: OFFICE OF MENTAL HEALTH

MARK	DATE	DESCRIPTION
1	03-09-2016	ADDENDUM no.1
	11-10-2015	BID DOCUMENTS
PROJECT NUMBER:		44902 - C
DESIGNED BY:		A. WILDEY-MCGILL
DRAWN BY:		W. MCGILL
FIELD CHECK:		
APPROVED:		

GRADING PLANS  
CLARKSON AVENUE  
DRIVEWAY ENTRANCES

DRAWING NUMBER:  
C-119

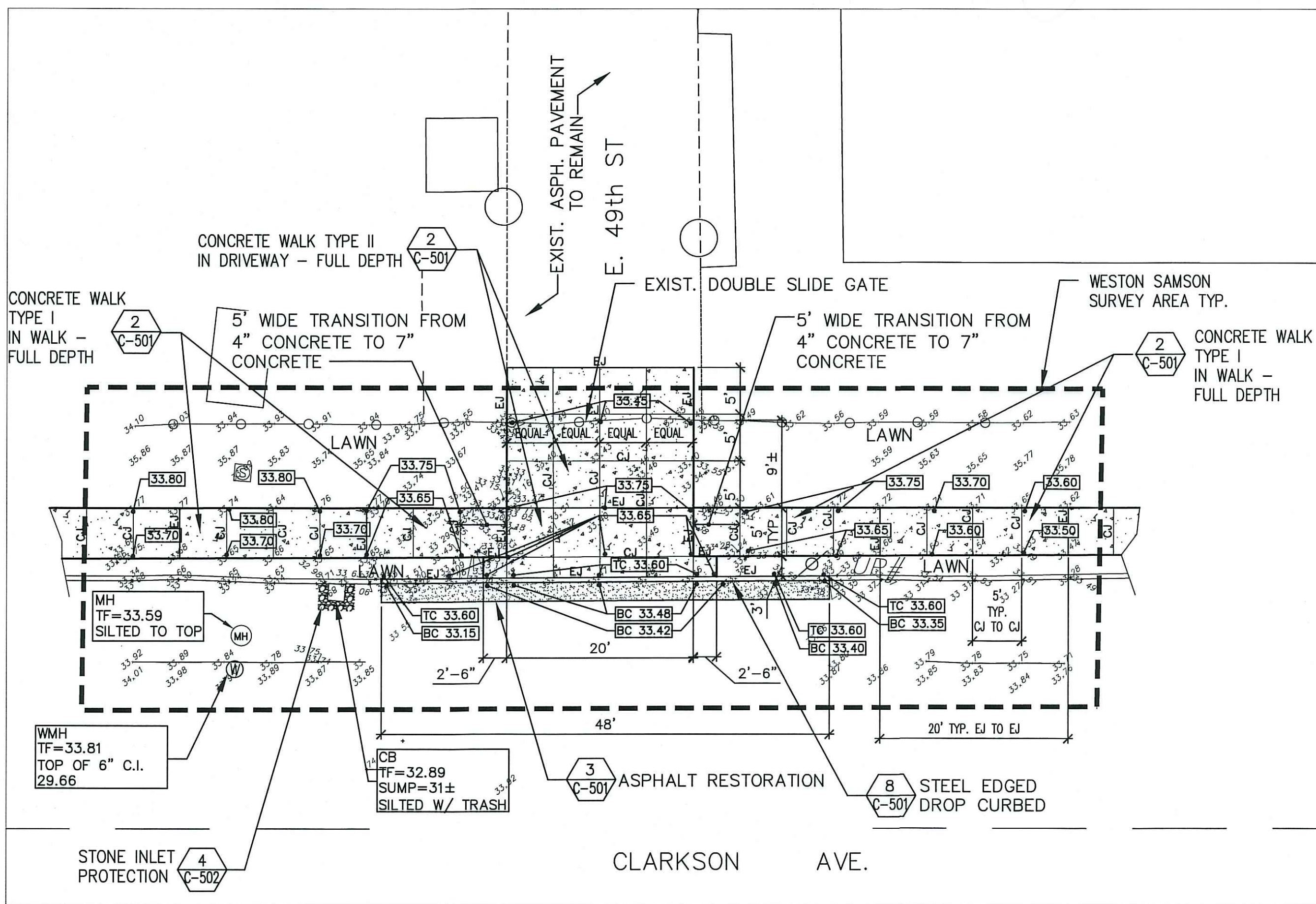

ENLARGEMENT A  
C-119

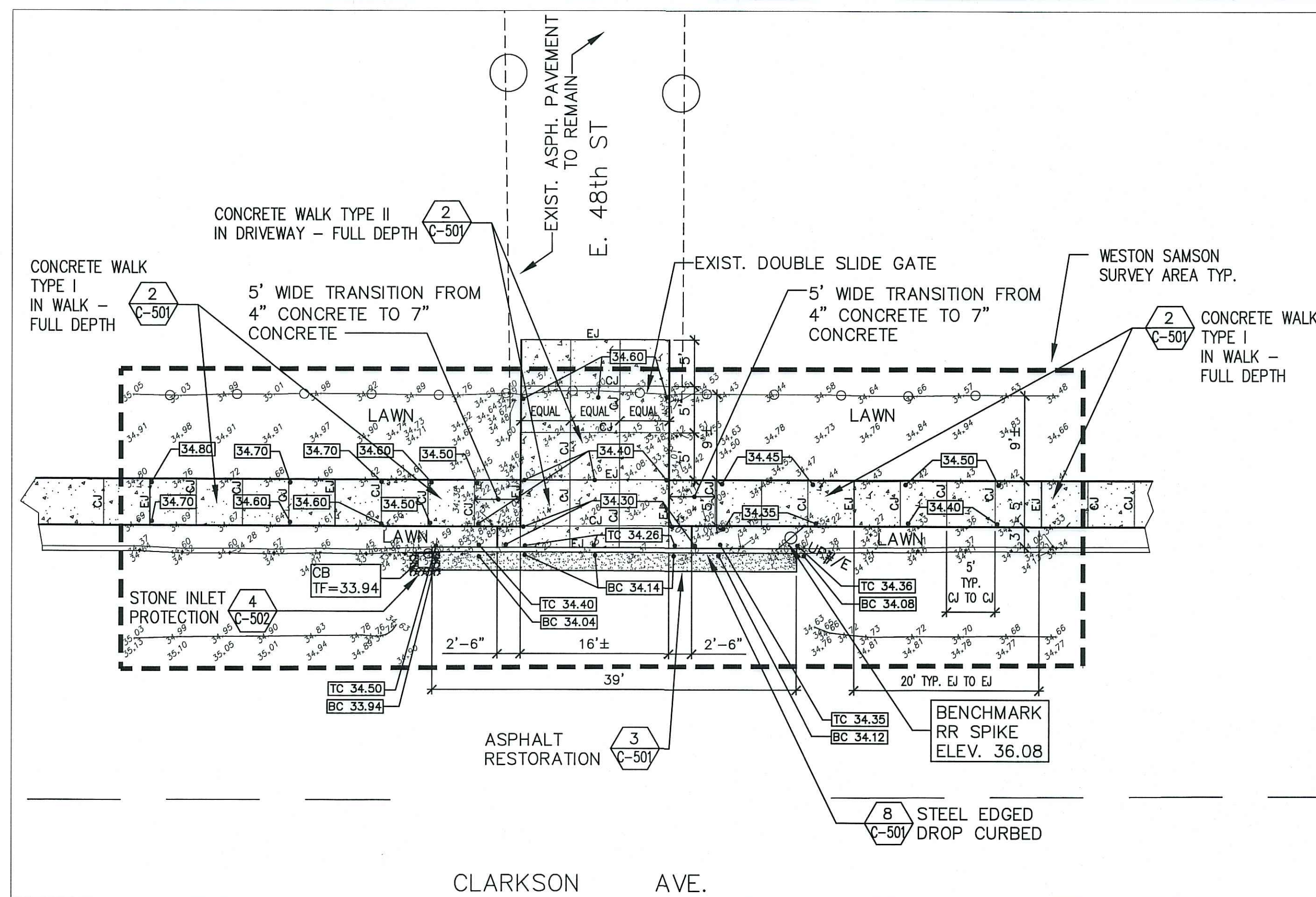

ENLARGEMENT B  
C-119

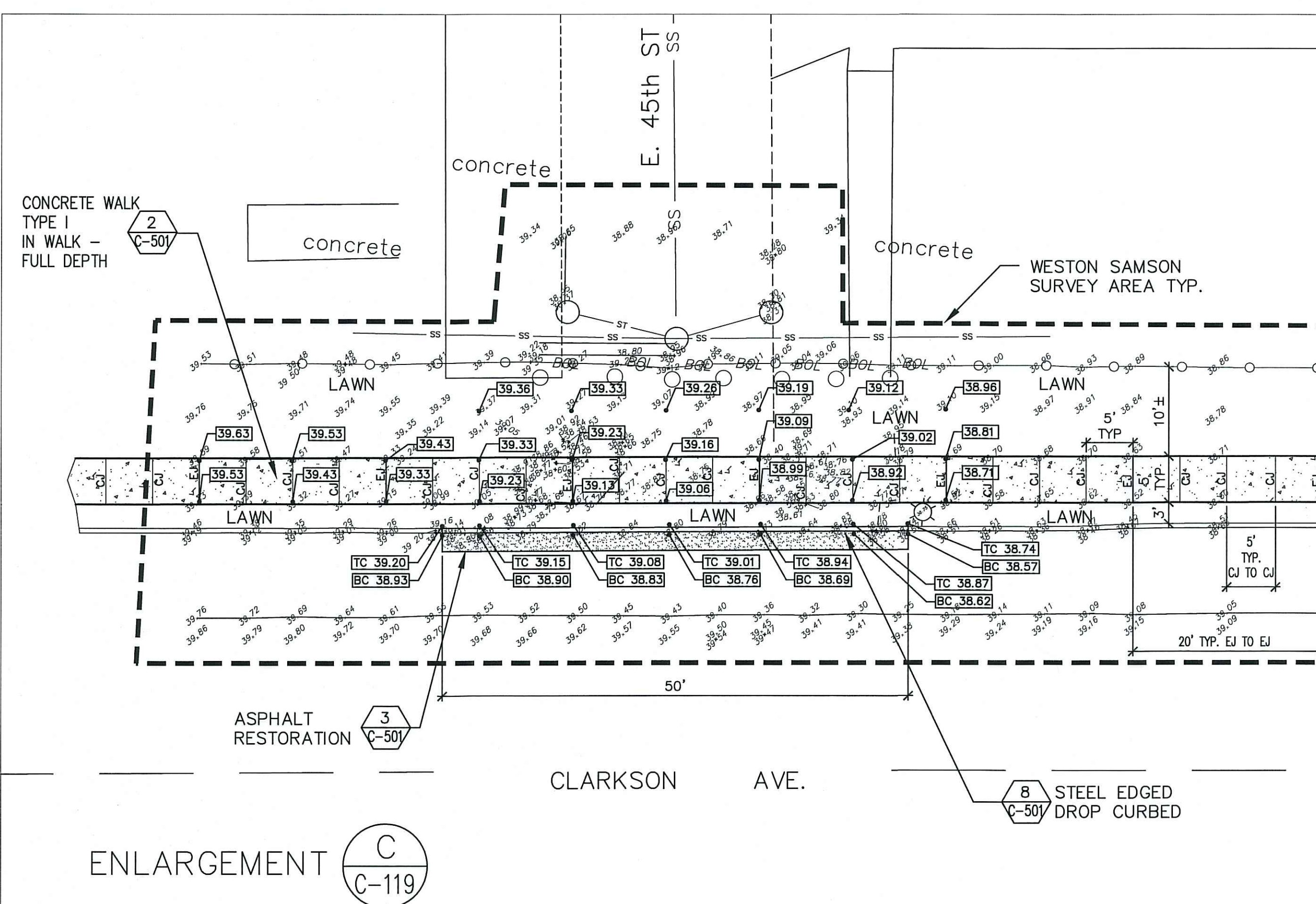

ENLARGEMENT C  
C-119

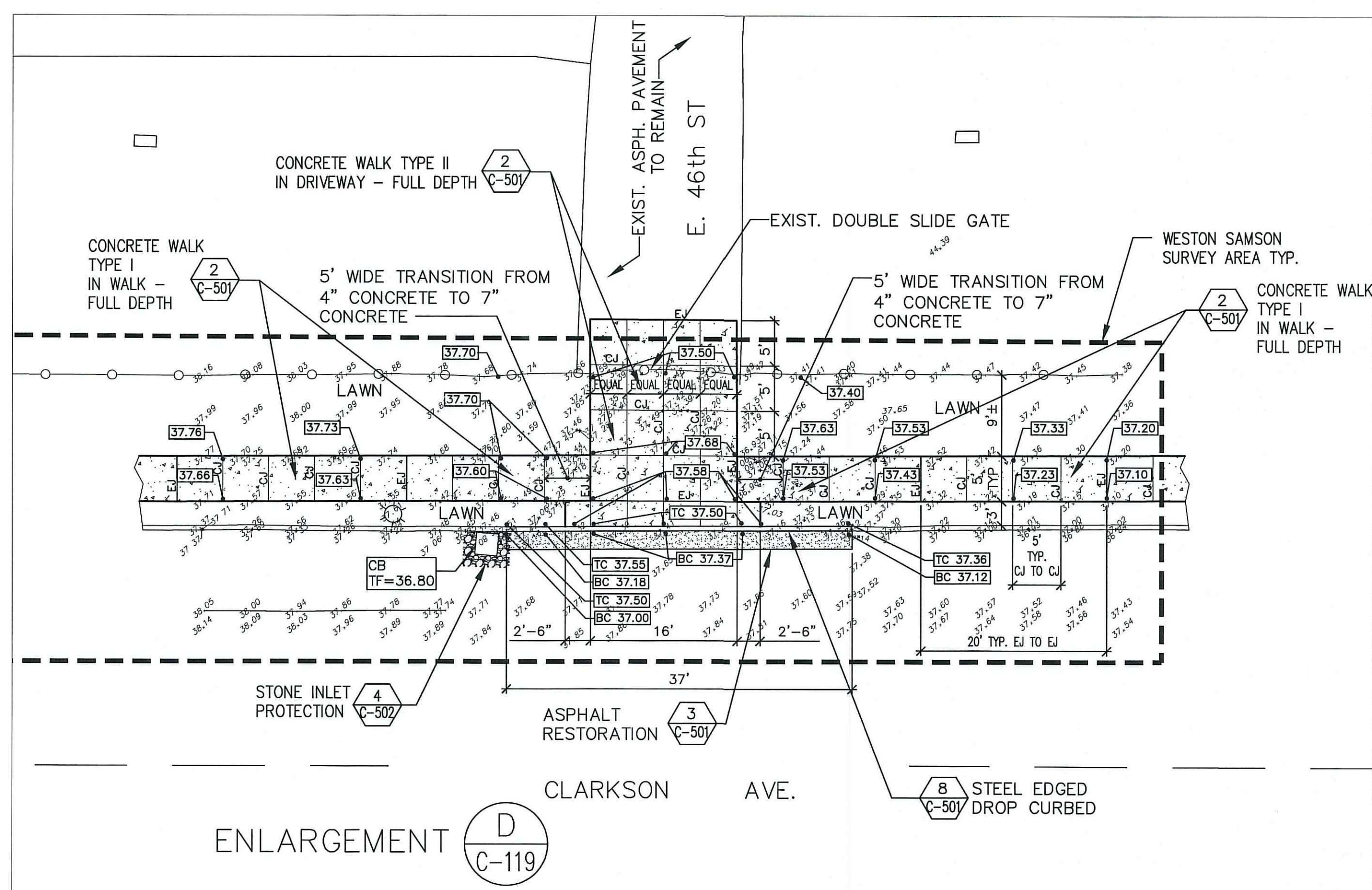

ENLARGEMENT D  
C-119

DRIVEWAY ENLARGEMENTS

SCALE: 1" = 10'-0"

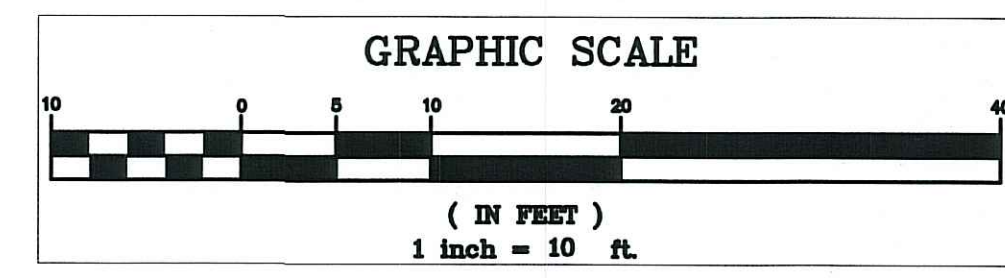
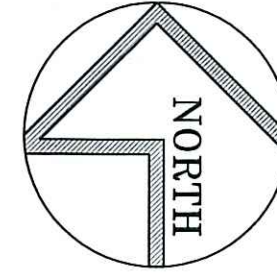

Mar 01, 2016 - 9:44am  
V:\Design\Construction\44902\CadSite\44902-119 DRIVEWAY.dwg  
36x24 PLOT SHEET