



**DESIGN & CONSTRUCTION GROUP
THE GOVERNOR NELSON A. ROCKEFELLER
EMPIRE STATE PLAZA
ALBANY, NY 12242**

ADDENDUM NO. 2 TO PROJECT NO. 46226-C

**CONSTRUCTION WORK
REHABILITATE RESTROOMS
STATE ARMORY
955 WASHINGTON ST.
PEEKSKILL, NY**

July 31, 2020

NOTE: This Addendum forms a part of the Contract Documents. Insert it in the Project Manual. Acknowledge receipt of this Addendum in the space provided on the Bid Form.

SPECIFICATIONS

1. SECTION 081434 REPLACEMENT OF HISTORIC WOOD DOORS: page 081434-3, item 3.01.A revise "Carefully remove existing damaged and altered doors to be replaced and label with location" to "Carefully remove existing damaged and altered doors to be replaced and label with location. Door refinishing and /or repair is to be performed offsite and temporary operable doors must be installed to maintain egress and code compliance until the refinished / repaired doors are reinstalled. Offsite refinishing / repair must be performed by an Acceptable Manufacturer per section 1.03.
2. SECTION 087100 FINISH HARDWARE: Discard all previously issued versions and substitute the accompanying Section (pages 087100-1 thru 087100-12).
3. SECTION 096429 WOOD STRIP FLOORING: Discard all previously issued versions and substitute the accompanying Section (pages 096429-1 thru 096429-3).
4. SECTION 099101 CONSTRUCTION PAINTING: page 099101-5, item 3.02.C.1.b revise "Gypsum Wallboard: fill and sand smooth minor bedding and finishing compound defects" to "Fill and sand smooth minor bedding and finishing compound defects."

DRAWINGS

5. Drawing No. A-101
 - a. Doors 4 and 4A: Delete Keynote 23 and replace with Keynote 20.
 - b. Door 7: Replace graphic from single door to double door.
 - c. Door 9: Reverse the door swing graphic such that the existing condition shows that the door swings into the building.
6. Drawing No. A-600
 - a. Revised Door Schedule. See revised drawing.
7. Drawing No. ID-101
 - a. Added Abbreviations Legend. See revised drawing.

8. Drawing No. H-100
 - a. Note the following: The ceiling in the basement is open below the toilet rooms, with the exception of the area under the existing toilets and urinals in the Women's room which has a gypsum board ceiling. Some existing plumbing pipes are located above this ceiling.
 - b. Note the following: There is tan paper beneath the wood floor in the drill hall. Two samples of the suspect tan paper were collected and one sample was found to be "No Asbestos Detected". The second sample could not be analyzed due to the limited quantity.

9. Drawing No. M-101
 - a. General Notes: Add 3. Building Management System Vendor is Trane.

10. Drawing No. E-001
 - a. General Notes: Add 6. Fire Alarm System Vendor is Red Hawk.

END OF ADDENDUM

Erik T. Deyoe, P.E.
Director, Division of Design
Design & Construction

SECTION 087100

FINISH HARDWARE

PART 1 GENERAL

1.01 REFERENCES

- A. NFPA 80 Fire Doors and Windows (2016).
- B. NFPA 101 Life Safety Code (2018).
- C. Building Code of New York State (2020).
- D. ICC/ANSI A117.1-2003 Accessible and Usable Buildings and Facilities.
- E. ANSI/BHMA Standard A156.1 Butts and Hinges (2006).
- F. ANSI/BHMA Standard A156.4 Door Controls – Closers (2008).
- G. ANSI/BHMA Standard A156.6 Architectural Door Trim (2005).
- H. ANSI/BHMA Standard A156.7 Template Hinge Dimensions (2009).
- I. ANSI/BHMA Standard A156.8 Door Controls – Overhead Stops and Holders (2005).
- J. ANSI/BHMA Standard A156.13 Mortise Locks and Latches Series 1000 (2005).
- K. ANSI/BHMA Standard A156.16 Auxiliary Hardware (2008).
- L. ANSI/BHMA Standard A156.18 Materials and Finishes (2006).
- M. ANSI/BHMA Standard A156.22 Door Gasketing Systems (2005).
- N. ANSI/BHMA Standard A156.26 Continuous Hinges (2006).
- O. DHI - Door and Hardware Institute.
- P. NAAM Standard HMMA 800-96- Hollow Metal Manufacturers Association.
- Q. NAAM Standard HMMA 831-97 Recommended Hardware Locations for Custom Hollow Metal Doors and Frames.
- R. 2010 Standards for State and Local Government Facilities: Title II.

1.03 DEFINITIONS

- A. Architectural Hardware Consultant (AHC): A Door and Hardware Institute certified expert in complex architectural openings requiring advanced knowledge of model building codes and safety standards, ADA requirements, access control knowledge and installation expertise.

- B. Architectural Hardware Distributor: A company that regularly purchases architectural hardware from manufacturers and specializes in the sale, service and support of that hardware to contractors and/or end users.
- C. Company Field Advisor(s): Hardware manufacturers' representatives who are certified in writing by manufacturer to be technically qualified in design, installation, and servicing of products.
- D. Installation Supervisor: Designated supervisor/installer, who has a minimum three years experience in finish hardware installation, and is qualified and responsible to ensure approved finish hardware is installed, adjusted, and operates properly.

1.04 SUBMITTALS

- A. Waiver of Submittals: The Waiver of Certain Submittal Requirements in Section 013300 does not apply to this Section.
- B. Re-Evaluation Fee: In accordance with the General Conditions 07213 Article 4.7.
- C. Submittal Package Cover Sheets: The Hardware Distributor shall provide a cover sheet, which identifies each package by:
 - 1. OGS project number.
 - 2. Project name.
 - 3. Facility name and location.
 - 4. Submittal Package name.
 - 5. Specification section name and number.
 - 6. Construction Contractor's company name, address, e-mail address, and telephone number.
 - 7. Finish Hardware Distributor's company name, address, e-mail address, and telephone number.
 - 8. Certified Architectural Hardware Consultant's name, company name, address, e-mail address, and telephone number.
 - 9. Submittal Date.
- D. Submittal Packages
 - 1. Quality Control Package: Do not submit balance of packages until this package is approved.
 - a. Architectural Hardware Consultant Data:
 - 1) Provide name, business address, and telephone number of DHI certified Architectural Hardware Consultant.
 - 2) Submit photocopy of Door and Hardware Institute's certificate demonstrating individual is an Architectural Hardware Consultant.
 - b. Company Field Advisor Data:
 - 1) Provide name, business address, and telephone number of Company Field Advisor(s) for continuous hinges, door bolts, locksets, overhead stops, door closers, and gaskets.

- 2) List services and products for which company field advisor(s) is/are certified by manufacturer. Provide written certifications.
- c. Hardware Distributor's Qualification Data:
 - 1) Provide the Finish Hardware Distributor's company name, address, e-mail address, and telephone number.
 - 2) Provide the hardware distributor's company history, including number of years in the hardware distribution business, the number of AHC's employed, and the number of employees. Describe the distributor's major market.
 - 3) Include the names and contact information of physical plant managers for 3 facilities, similar to this project, for which the distributor has furnished architectural hardware within the past 2 years.
- d. Supervisor's/Installer's Qualification Data:
 - 1) Name of Supervisor and each installer performing Work, and employer's name, business address and telephone number.
 - 2) Names and addresses, and contact information of physical plant managers for 3 facilities, similar to this project, on which each installer has worked on during past 2 years.
2. Finish Hardware Package:
 - a. Finish Hardware Schedule: Use vertical format and indicate finish hardware items, both mechanical and electrical in one document, required to complete Work of this section. Submit Hardware Schedule that includes complete hardware sets for each door and frame shown on Door Schedule.
 - 1) Preface schedule with following:
 - a) Certified Architectural Hardware Consultant's statement of preparation of/or certification of, Finish Hardware Schedule.
 - b) Index.
 - c) List of manufacturers.
 - d) List of finishes.
 - e) Explanation of abbreviations.
 - f) Keying instructions and key schedule.
 - 2) Create hardware groups, each group consisting of similar doors and hardware. Do not combine labeled and non-labeled openings. Do not combine doors and frames with dissimilar door sizes and/or materials.
 - 3) For each opening include the following:
 - a) Door and frame materials and dimensions.
 - b) Fire rating.
 - c) Door number, location and handing.
 - d) Degree of opening required for closer and/or overhead stop.
 - e) Installation and detailing notes.
 - 4) Under each group heading, list hardware items in detail, required for ordering. For each hardware item include:
 - a) Type (Hinges).
 - b) Quantity (Hinges 3ea).

- c) Manufacturers' name (Hinges 3ea Stanley).
 - d) Catalog number (Hinges 3ea Stanley FBB199).
 - e) Size (Hinges 3ea Stanley FBB199 4 ½ x 4 ½).
 - f) Options or accessories (Hinges HTFBB199 4 ½ x 4 ½).
 - g) Finish (Hinges HTFBB199 4 ½ x 4 ½ x 630).
 - h) Fasteners (Hinges HTFBB199 4 ½ x 4 ½ x 630 x torx with center security pin).
 - i) Indicate location of protection plates: Push side or pull side.
 - j) Installation Notes, as written in this section, for each hardware group.
- 5) Use a separate hardware group in Hardware Schedule that lists attic stock hardware items, key cabinets, key control system, special tools required to install hardware, lubricants, and Operations and Maintenance Manuals.
- b. Product Data: Furnish six copies of manufacturers' catalog sheets, specifications, sizing charts, and installation instructions, for each item specified. Highlight information pertaining specifically to product (s) submitted.
- c. Submit samples as requested.
3. Closeout Submittals Package: Submit as a complete package.
- a. Operation and Maintenance Manuals: Furnish 2 hardcover three ring binders with the project name and number displayed on the front cover and spine. Include:
- 1) List of Manufacturers.
 - 2) Approved Finish Hardware Schedule.
 - 3) Approved Manufacturers' Product Data Sheets.
 - 4) Manufacturer's operation, installation, maintenance, and repair instructions for each type of hardware furnished.
 - 5) Templates for kind of hardware furnished.
 - 6) Parts List for each type of finish hardware furnished.
 - 7) Manufacturers' dated written warranty for each type of finish hardware furnished.
 - 8) Certifications: Written certification from Company Field Advisors that their products are installed according to manufacturers' printed installation instructions, are operating properly, and manufacturers' written warranty will be in effect upon physical completion of the Work.
 - 9) Special Tools: List of special tools required to install hardware, and their purpose.
- b. Special Tools:
- 1) At conclusion of finish hardware installation, turn over to Director's Representative 2 of each special tool required to install hardware together with a list of these tools and their purpose.

1.05 TEMPLATES

- A. After receipt of approved submittals, furnish templates to affected trades, to enable fabricators to make provision for finish hardware without delaying the Work of the Project.

1.06 DELIVERY AND STORAGE

- A. Coordinate delivery to avoid delay.
- B. Clearly label each item for identification and installation location as it corresponds to the approved Finish Hardware Schedule and subsequent information bulletins.
- C. Deliver hardware to the jobsite in the manufacturers' original packages complete with fasteners, parts, installation instructions, and templates required for proper installation.
- D. Inventory hardware at jobsite to identify shortages or backorders. Resolve delivery shortages and damaged items prior to installing hardware.
- E. Store finish hardware where directed by Director's Representative. Provide locked, dry storage for finish hardware.

1.07 QUALITY ASSURANCE

- A. Hardware Distributor's Qualification:
 - 1. Hardware Distributor who has been in the business of furnishing, and/ or installing finish hardware for a minimum of three years.
 - 2. Hardware Distributor shall have the DHI certified Architectural Hardware Consultant prepare or certify the Finish Hardware Submittal meets specification requirements, and the schedule is written accurately and in accordance with DHI recommendations, and requirements of this specification.
- B. Company Field Advisors: Employ advisor(s) for continuous hinges, door bolts, mortise locksets, surface overhead stops, door closers, and gaskets.
- C. Installation Supervisor: Employ a qualified Installation Supervisor who will be responsible to ensure approved finished hardware is installed, adjusted and operates properly.
- D. Installers: Employ experienced finish hardware installers who have been regularly employed by a Company installing finish hardware for a minimum of 5 years.
- E. Pre-submittal Conference: Before Finish Hardware Submittals are written for submission, the Director's Representative will call a teleconference to review Finish Hardware Submittal requirements including but not limited to format, cover sheet, headings, hardware sets, level of detail, installation notes, description of operation, keying, and product data sheets. The Contractor, the Finish Hardware Distributor, the Finish Hardware Detailer, and consulting

hardware designer, and OGS Designers shall attend. The OGS Finish Hardware Reviewer shall conduct the conference.

- F. On Site Pre-installation Conference: Before finish hardware installation begins, the Director's Representative will call a conference at the site to review Finish Hardware Specifications, approved Finish Hardware Submittals, and to discuss requirements for the Work including:
1. Hardware delivery and storage.
 2. Hardware labeling by door number.
 3. Hardware locations.
 4. Potential location conflicts.
 5. Hardware installation sequence and responsibility.
 6. Required accessories and fasteners.
 7. Continuous hinge installation.
 8. Surface overhead stops and closer template and adjustments.
 9. Special tools and maintenance items.
 10. Hardware Closeout requirements.
 11. Hardware Warranties.
- G. Pre-installation Conference Attendance: The Construction Contractor, Company Field Advisors, authorized Finish Hardware Installers, and the Finish Hardware Distributor's Architectural Hardware Consultant shall attend the conference. OGS's Finish Hardware Reviewer conducts the meeting. OGS designers and facility personnel may attend. The Company Field Advisors will present installation instruction and advice.
- H. Pre-Benchmark-Construction Meeting: Prior to the construction of the mock-up, a meeting will be held at the site to review the requirements, and discuss the intent of the mock-up. The meeting will be scheduled by the Director's Representative and conducted by the Hardware Designer. The meeting shall be attended by the Director's Representative, the Hardware Designer, the Contractor's onsite foreman, the person supervising this phase of the Work (if different), and the person (people) who will be performing the work.
- I. Construction of Benchmark: Before installing portions of the Work requiring benchmarks, install benchmarks for each form of construction required to comply with the following requirements, using materials indicated for the completed Work.
1. Build hardware benchmark in door and frame assembly, specified in section 081102, in locations as directed, and include continuous hinge, lockset, closer, surface overhead stop and gaskets.
 2. Notify the Director's Representative in advance of dates and times when benchmark will be constructed.
 3. Install benchmark with supervisor oversight and workers who will be employed during the construction of the Work.
 4. Construct benchmarks using the exact materials, products, methods, and workmanship that were approved for the Work.
 5. Obtain Director's Representative's approval of benchmarks before starting work, fabrication, or construction.
 6. Maintain benchmarks during construction in an undisturbed condition as a standard for judging the completed Work.

- 7. Failure to maintain this standard of quality will be cause for rejection of the Work.
- 8. Benchmark may be used in the Work unless otherwise indicated.

- J. Uniformity of Hardware and Single Source Responsibility: For each kind of hardware provide product(s) of a single manufacturer.

- K. Size Variations: Manufacturers' products may vary slightly from sizes specified except where minimum size or thickness is specified.

1.08 WARRANTY

- A. Manufacturer's Warranty: Ten year minimum warranty for door closers.

- B. Manufacturer's Warranty: Three year minimum for locksets.

1.09 MAINTENANCE

- A. Special Tools: At the conclusion of finish hardware installation, turn over to Owner's Representative 2 sets of each special tools required for proper installation and adjustment of hardware, together with a list of these tools and their purpose.

- B. Lubricants: Provide manufacturer's recommended lubricants for locksets and closers sufficient for 1 year of maintenance. Turn over to Director's Representative.

PART 2 PRODUCTS

2.01 ACCESSORIES

- A. Provide brackets, plates, arms, spacers, and special templates to mount door closers in combination with overhead stops and coordinators, on narrow top rails and for special ceiling and jamb conditions.

- B. Provide curved lip strikes, with wrought boxes, specific to individual lock functions. Universal strikes that fit a variety of lock functions are not acceptable.

2.02 FASTENINGS

- A. Provide fasteners that harmonize with finish hardware material and finish.

- B. Provide machine screws for hardware secured to metal; and machine screws and metal expansion shields for attachment to masonry substrates. Self-tapping or self-drilling screws are not acceptable.

- C. Provide undercut shallow head torx center pin security fasteners where necessary for proper seating.

- D. Attach door closers and overhead stops with sex bolts.

2.03 MATERIALS AND FINISHES

- A. General: Requirements for design, grade, function, finish, size, and other distinctive qualities of each type of finish hardware are indicated in this section and in the Hardware Groups.
- B. Five-Knuckle, Ball Bearing Hinges
 - 1. Manufacturers and Products:
 - a. Scheduled Manufacturer and Product: Ives 5BB series
 - b. Acceptable Manufacturers and Products: Bommer BB series, Hager BB series
- C. Locks, Latches and Bolts
 - 1. Comply with UL requirements for throw of bolts and latch bolts on rated fire openings.
 - 2. Provide 3/4" minimum throw on other latch bolts.
 - 3. Provide 1" minimum throw deadbolts.
- D. Closers and Door Control Devices
 - 1. Closer bodies: Provide closer bodies with the same hole template pattern regardless of type or application.
 - 2. Closer arms: Non-handed forged steel.
 - 3. Closer size: Provide sized closers.
 - 4. Provide all-weather fluid to eliminate seasonal adjustment of closer speed.
 - 5. Powder coat closer body, arm, and adapter plate or pre-treat closer body, arm, and adapter plate with rust-inhibiting coating before painted finish is applied.

2.04 FINISH HARDWARE

Hardware Group No. 01

For use on Door #(s): 05, 14

Each Have:

3	EA	HINGE	5BB1 4.5 X 4.5	640	IVE
1	EA	CLASSROOM DEAD LOCK	L463L XB11-720	613	SCH
1	EA	MORTISE CYLINDER	AS REQUIRED	613	
1	EA	PUSH PLATE	8200 4" X 16"	613	IVE
1	EA	PULL PLATE	8305 8" 4" X 16"	613	IVE
1	EA	SURFACE CLOSER	SC71A RW/PA	695	FAL
1	EA	KICK PLATE	8400 10" X 1 1/2" LDW B-CS	613	IVE
1	EA	MOP PLATE	8400 4" X 1" LDW B-CS	613	IVE
1	EA	WALL STOP	WS406/407CVX	613	IVE
3	EA	SILENCER	SR64	GRY	IVE

Hardware Group No. 02

For use on Door #(s): 4

Each Have:

3	EA	HINGE	5BB1 4.5 X 4.5	640	IVE
1	EA	MORTISE OFFICE LOCK	L9050L 07A BY ALLOWANCE	613	SCH
1	EA	MORTISE CYLINDER	AS REQUIRED	613	
1	EA	SURFACE CLOSER	1450 REG/PA AS REQ'D	695	LCN
1	EA	KICK PLATE	8400 10" X 2" LDW B-CS	613	IVE
1	EA	WALL STOP	WS406/407CVX	613	IVE
1	EA	GASKET	488-SBK	BLK	ZER

Hardware Group No. 03

For use on Door #(s): 4A

Each Have:

3	EA	HINGE	5BB1 4.5 X 4.5	640	IVE
1	EA	MORTISE CLASSROOM LOCK	L9070L 07A BY ALLOWANCE	613	SCH
1	EA	MORTISE CYLINDER	AS REQUIRED	613	
1	EA	SURFACE CLOSER	1450 REG/PA AS REQ'D	695	LCN
1	EA	KICK PLATE	8400 10" X 2" LDW B-CS	613	IVE
1	EA	WALL STOP	WS406/407CVX	613	IVE
1	EA	GASKET	488-SBK	BLK	ZER

Hardware Group No. 04

For use on Door #(s): 18

Each Have:

4	EA	HINGE	5BB1 5 X 4.5 NRP	640	IVE
1	EA	RIM EXIT DEVICE	98-NL	613	VON
1	EA	RIM CYLINDER	AS REQUIRED	613	
1	EA	SURFACE CLOSER	LCN 4050 SCUSH X ST-2480 (ARCH TOP MTG BRACKET)	695	LCN
1	EA	KICK PLATE	8400 10" X 2" LDW B-CS	613	IVE
1	EA	RAIN DRIP	142D	DKB	ZER
1	EA	DOOR SWEEP	8197D	DKB	ZER
1	EA	THRESHOLD	545D	DKB	ZER
1	EA	GASKET	488-SBK	BLK	ZER

Hardware Group No. 05

For use on Door #(s): 09

Each Have:

6	EA	HINGE	5BB1 5 X 4.5 NRP	640	IVE
1	EA	SVR EXIT DEVICE	CD-9827-NL	613	VON
1	EA	SVR EXIT DEVICE	CD-9827-DT	613	VON
1	EA	RIM CYLINDER	AS REQUIRED	613	
2	EA	SURFACE CLOSER	LCN 4050 SCUSH X ST-2480 (ARCH TOP MTG BRACKET)	695	LCN
2	EA	KICK PLATE	8400 10" X 1-1/2" LDW B-CS	613	IVE
1	EA	RAIN DRIP	142D	DKB	ZER
2	EA	DOOR SWEEP	8197D	DKB	ZER
1	EA	THRESHOLD	545D	DKB	ZER
1	EA	MEETING STILE	8217-SBK	BLK	ZER
		GASKET			
1	EA	GASKET	488-SBK	BLK	ZER

2.05 KEYING

- A. Continue existing key system established for Facility.
1. Stamp key symbol on one side of key, and "Do Not Duplicate" on other side of key.
 3. Furnish one copy of factory bitting list to facility.
 4. Factory key cylinders.
 5. Furnish 3 cut keys for each master key.
 6. Furnish 7 cut keys for each keyed lockset.
 7. These cut key quantities are for bidding purposes only. Actual number of cut keys required will be determined at keying meeting.
 8. When lockset and cylinder are by different manufacturers, identify and furnish correct cylinder cam to operate lockset.

9. Provide compression rings and spacers to achieve proper spacing relationship between cylinder and face of door.
- B. Keying Conference
1. Immediately following contract award, Director's Representative will schedule a keying conference to develop a written key schedule that reflects Facility's specific keying requirements. Facility Representative(s), Hardware Distributor, Consulting Hardware Designer, and OGS's Hardware Designer will attend.
 2. Incorporate this schedule in Finish Hardware Submittals for approval.

PART 3 EXECUTION

3.01 EXAMINATION

- A. Examine doors and frames and related items for conditions such as, but not limited to, incorrect handing, hardware preparation, misaligned lock and strike preparations, that would prevent proper application of finish hardware. Do not proceed until defects are corrected.
- B. Report conditions or hardware applications that are incorrect to the Director's Representative.

3.02 INSTALLATION

- A. Do not proceed with installation of finish hardware prior to attending referenced pre-installation conference.
- B. Installation Sequence: Use proper installation sequence, i.e., install coordinators, and overhead stops and holders before surface mounted door closers.
- C. Install hardware in accordance with manufacturer's printed installation instructions, and adjust for smooth operation, free of sticking, binding or rattling.
1. Template surface overhead stops and holders for proper operation
 2. Template and adjust closers for proper operation.
- D. Use proper tools and methods to prevent scratches, burrs or other defacement.
- E. Threshold Installation:
1. Drill holes 3 inches from each end of threshold and intermediate holes 12 inches maximum o.c. for required fasteners. Prepare holes for countersunk fasteners.
 2. Level and align thresholds with frames and doors. Where required, use non-corrosive shims.
 3. Exterior Doors: Set thresholds in a solid bed of Type 3 sealant.
 4. Secure thresholds to substrate with countersunk fasteners.
- H. After installation, cover and protect hardware to prevent damage during remaining construction. Remove protection upon completion of construction.

3.03 LOCATIONS

- A. Locate hardware as follows:
 - 1. Door Closers: Template for maximum door swing allowed by wall placement and jamb conditions. Where overhead stop prevents door from swinging to wall, template the closer to exceed degree of opening allowed by overhead stop.
 - 2. Protection Plates: 1/8 inch from door bottom.
 - 3. Wall Stops: Centerline of bumper to match centerline of locking trim.

3.04 FIELD QUALITY CONTROL

- A. Post Installation Review: After hardware is adjusted for proper operation, Director's Representative will hold a Post-Installation Review with the Contractor, Hardware Designer, Company Field Advisors, Hardware Distributor and Hardware Installers.
 - 1. Physically inspect to verify proper application, installation, adjustment and operation of finish hardware, and in particular that:
 - a) Latches engage freely without binding. Filing of strike plates to relieve latch bind is not acceptable.
 - b) Closers are adjusted for proper spring power; sweep speed, latching speed; and hydraulic back check.
 - c) Locations and proper attachment of installed protective hardware are as specified.
 - d) There is no field modification of fasteners.
 - e) Damaged fasteners are replaced.
 - 2. Defective hardware is repaired or replaced.
 - 3. Hardware is to be left clean and free from disfigurement.
- B. Turn referenced Operations and Maintenance Manuals over to Facility through Director's Representative.

END OF SECTION 087100

SECTION 096429

WOOD STRIP FLOORING

PART 1 GENERAL

1.01 RELATED WORK SPECIFIED ELSEWHERE

- A. Subflooring: Rough Carpentry 061000

1.02 SUBMITTALS

- A. Shop Drawings: Show direction of flooring and details at walls, doorways and openings, and obstructions interrupting flooring.
- B. Product Data: Catalog sheets, specifications, and installation and application instructions for the following:
 - 1. Each wood strip flooring type specified.
 - 2. Fasteners.
 - 3. Compressible Filler.
 - 4. Cove Base Adhesive
- C. Samples:
 - 1. Strip Flooring, each type specified: Approximate 18 inch lengths showing tongues, grooves, and end matches.
 - 2. Sheathing Paper: Two 12 inch square pieces.
 - 3. Fasteners: One each type specified.
- D. Quality Control Submittals:
 - 1. Certificates: Affidavit required under Quality Assurance Article.

1.03 QUALITY ASSURANCE

- B. Grading Rules: Maple Flooring Manufacturers' Association (MFMA) Grading Rules For Hard Maple.
 - 1. Flooring shall be plainly marked with the MFMA trade mark.
- C. Certification: Affidavit certifying that each shipment of flooring complies with the contract requirements.

1.04 DELIVERY, STORAGE, AND HANDLING

- A. Packing and Shipping:
 - 1. Deliver flooring bundles to the Site with association trade mark showing.
 - 2. Deliver finishing materials to the Site in unopened original containers, bearing manufacturer's labels.
- B. Storage and Protection: Store flooring in a manner to protect it from the weather and absorption of moisture.
 - 1. Move flooring into

1.05 PROJECT CONDITIONS

- A. Environmental Requirements:
 - 1. Do not install flooring until wet work is completed and ambient air at installation area has moisture content stabilized.
 - 2. Make arrangements, through the Director's Representative, to maintain a minimum temperature of 65 degrees F and a relative humidity of 50 percent or lower for a period of 2 days before delivery of flooring, during, and 2 days after installation.

1.06 SEQUENCING AND SCHEDULING

- A. Scheduling: Do not perform the Work of this Section until all trades have completed all items above the floor area.

PART 2 PRODUCTS

2.01 MATERIALS

- A. Maple Strip Flooring: Northern hard maple flooring; 25/32 thickness, 2-1/4 inches face width; second and better grade; sides tongued and grooved, ends matched; 8 percent maximum moisture content.
- B. Wall Base: Rubber vented cove base; 4" high with 3" toe.
 - 1. Color: Black
 - 2. Fire Resistance: Class 1
 - 3. Adhesive: Manufacturer's recommended adhesive for porous substrate.
- C. Sheathing Paper: No. 15 asphalt saturated felt, non-perforated, ASTM D 226.
- D. Fasteners; Either of the following:
 - 1. 15 gage epoxy coated staples specifically designed for wood strip flooring.
 - 2. Two inch barbed cleats specifically designed for wood strip flooring.
- E. Compressible Filler: Yellow cork or other approved compressible material.
- F. Finishing Materials:
 - 1. Finish; Oil-Free Waterborne Polyurethane Coating: FS TT-C-542, Type II, Class A.
 - 2. Sealer: Finish manufacturer's recommended sealer.

2.02 FABRICATION AND MANUFACTURE

- A. Maple flooring shall be manufactured in accordance with the requirements of the Maple Flooring Manufacturers' Association.

PART 3 EXECUTION

3.01 PREPARATION

- A. Prohibit traffic in spaces to receive wood flooring.
- B. Broom clean substrate.
- C. Acclimate flooring to the temperature and humidity in installation area.
- D. Clean and prepare masonry wall surface to receive wall base adhesive.

3.02 INSTALLATION

- A. Place sheathing paper over entire substrate. Lap edges and ends a minimum 2 inches and fasten in place.
- B. Lay flooring with the longest dimension of the floor area. Machine fasten flooring to substrate.
- E. Install flooring with a one inch expansion void at the perimeter of the floor and around permanent building features penetrating through the flooring. Fill permanently exposed voids with compressible material.
- F. Install vented cove base. Use cove base manufacturer's recommended adhesive for porous substrate.

3.03 SURFACING

- A. Machine sand flooring with drum sander, edger, and buffer using coarse, medium, and fine sandpaper. Sand flooring to a smooth, even, uniform surface without drum stop marks, gouges, streaks, or shiners.
- B. Remove all sanding dust from surface and joints of floor.

3.04 FINISHING

- A. Apply sealer and finish in accordance with manufacturer's printed instructions.
 - 1. Apply one coat of sealer and 2 coats of finish. Buff and clean between each coat after preceding coat is dry.
 - 2. Buff and clean the final coat of finish when dry.

END OF SECTION



WARNING:
THE ALTERATION OF THIS MATERIAL IN ANY WAY, UNLESS DONE UNDER THE DIRECTION OF A COMPARABLE PROFESSIONAL, I.E. ARCHITECT FOR AN ARCHITECT, ENGINEER FOR AN ENGINEER OR LANDSCAPE ARCHITECT FOR A LANDSCAPE ARCHITECT, IS A VIOLATION OF THE NEW YORK STATE EDUCATION LAW AND/OR REGULATIONS AND IS A CLASS 'A' MISDEMEANOR.

CONTRACT: **CONSTRUCTION**
TITLE: **REHABILITATE RESTROOMS**
LOCATION: **STATE ARMOY
955 WASHINGTON ST.
PEEKSKILL, NY**
CLIENT: **DIVISION OF MILITARY AND
NAVAL AFFAIRS**

MARK	DATE	DESCRIPTION
2	7/29/2020	BID ADDENDUM #2
6	6/16/2020	BID DOCUMENTS
1	7/20/2020	BID ADDENDUM #1

PROJECT NUMBER:	46226-C
DESIGNED BY:	MJF
DRAWN BY:	KKS
FIELD CHECK BY:	MJF
APPROVED BY:	MJF

SHEET TITLE: **DOOR SCHEDULE, DETAILS & FRAMES TYPES**

DRAWING NUMBER: **A-600**

SHEET OF 26

NUMBER	DOOR				FRAME			GLASS TYPE	FIRE RATING	REMARKS
	WIDTH	HEIGHT	THICKNESS	HARDWARE SET	TYPE	MATERIAL	FINISH			
02	6'-0"	7'-0"	1 3/4"		EXIST	WD	STAIN	EXIST	-	REFINISH DOOR / FLIP SWING
4	3'-0"	7'-0"	1 3/4"	2	A	WD	STAIN	1	HM	PT
4A	2'-6"	7'-0"	1 3/4"	3	A	WD	STAIN	1	HM	PT
05	3'-0"	7'-0"	1 3/4"	1	A	WD	STAIN	1	HM	PT
7	5'-0"	7'-0"	1 3/4"		EXIST	WD	STAIN	EXIST	-	REFINISH DOOR & TRANSOM
8	2'-8"	7'-0"	1 3/4"		EXIST	WD	STAIN	EXIST	-	REFINISH DOOR
8A	2'-7"	7'-0"	1 3/4"		EXIST	WD	STAIN	EXIST	-	REFINISH DOOR & TRANSOM
9	7'-0"	7'-0"	1 3/4"	5	D	WD	STAIN	3	-	REPLICATE ORIGINAL HISTORIC DOOR
9A	7'-0"	7'-0"	1 3/4"		EXIST	WD	STAIN	EXIST	-	REFINISH DOOR & REVERSE SWING DIRECTION
10	7'-0"	7'-0"	1 3/4"		C	WD	STAIN	EXIST	-	REPAIR, & REFINISH DOOR.
10A	2'-6"	7'-0"	1 3/4"		EXIST	WD	STAIN	EXIST	-	REFINISH DOOR
10B	2'-6"	7'-0"	1 3/4"		EXIST	WD	STAIN	EXIST	-	REFINISH DOOR
12	2'-8"	7'-0"	1 3/4"		EXIST	WD	STAIN	EXIST	-	REFINISH DOOR & TRANSOM
13	6'-0"	7'-0"	1 3/4"		EXIST	WD	STAIN	EXIST	-	REFINISH DOOR
14	3'-0"	7'-0"	1 3/4"	1	A	WD	STAIN	1	HM	PT
16	3'-0"	7'-0"	1 3/4"		EXIST	WD	STAIN	EXIST	-	REFINISH DOOR & TRANSOM
18	3'-6"	8'-0"	1 3/4"	4	B	WD	STAIN	2	-	REPLICATE EXISTING HISTORIC DOOR
18A	6'-0"	7'-0"	1 3/4"		EXIST	WD	STAIN	EXIST	-	REFINISH DOOR
18B	6'-0"	7'-0"	1 3/4"		EXIST	WD	STAIN	EXIST	-	REFINISH DOOR

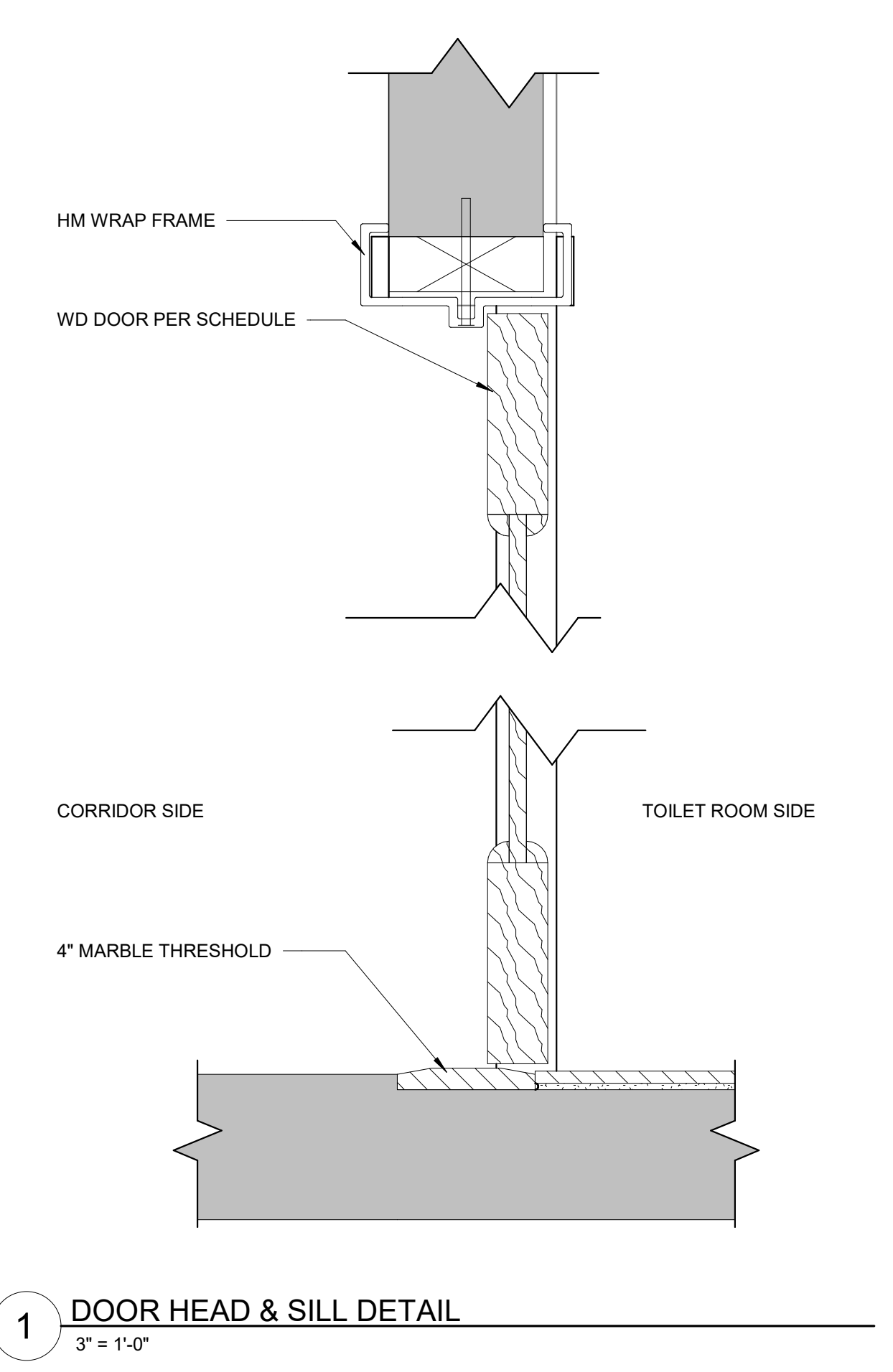
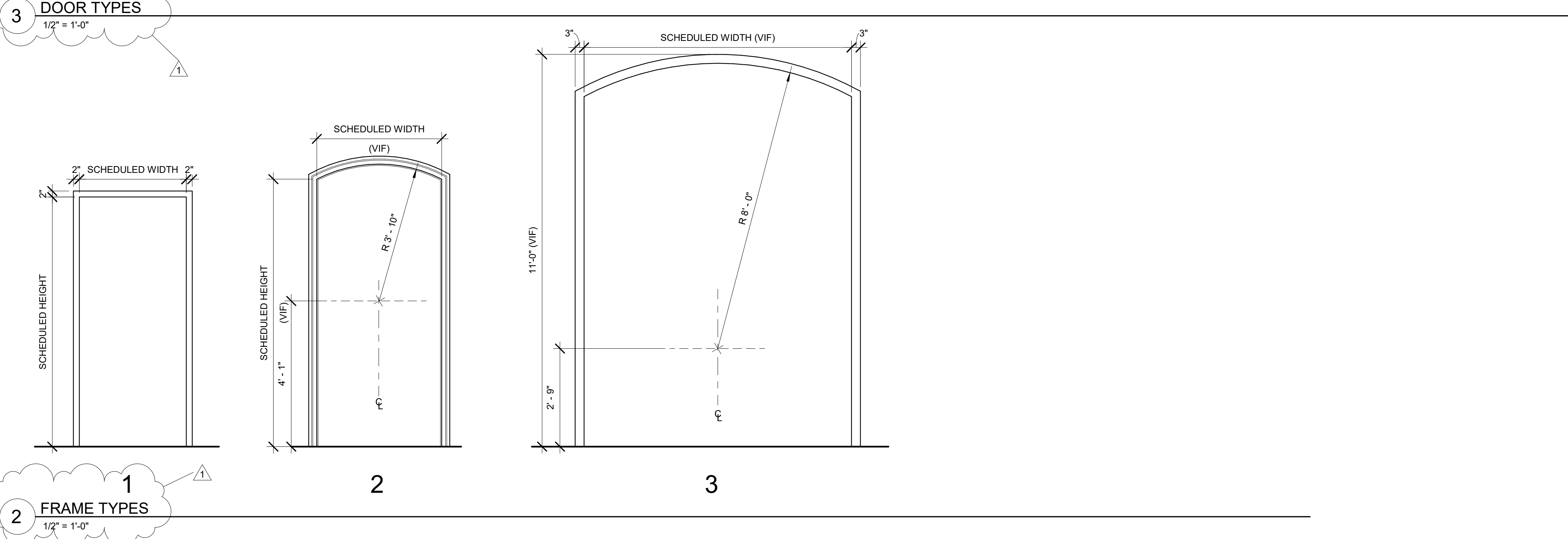
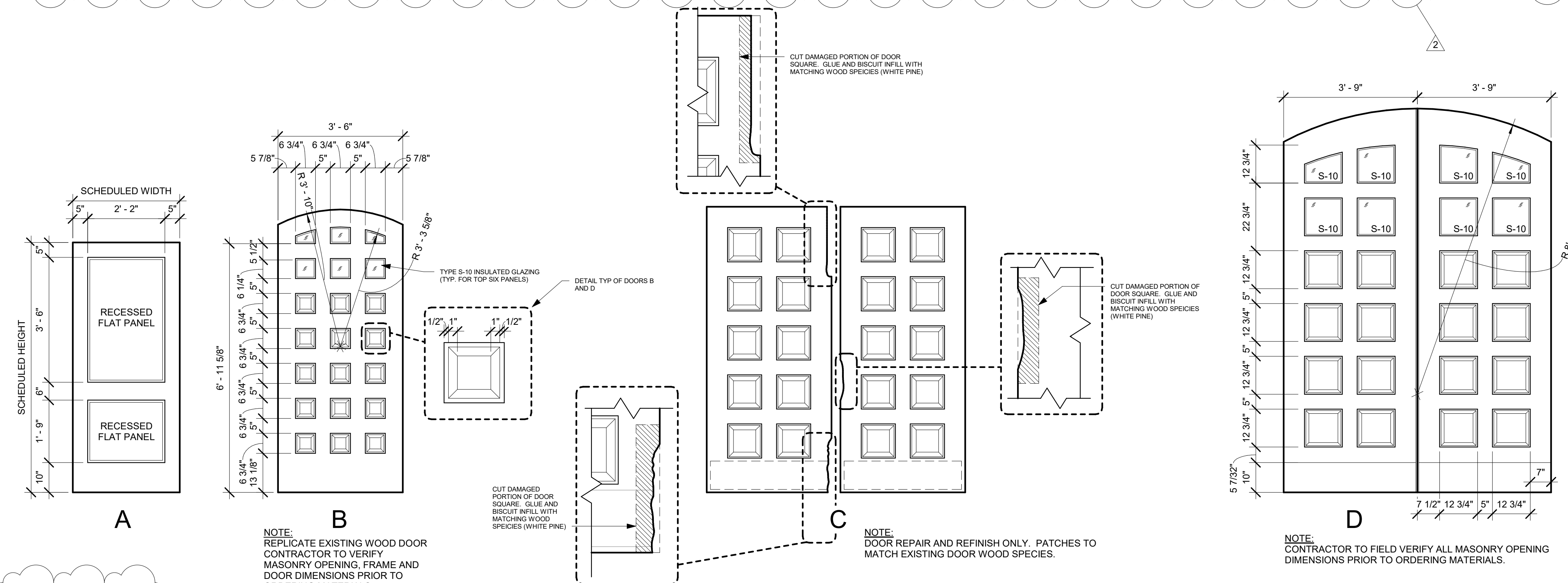
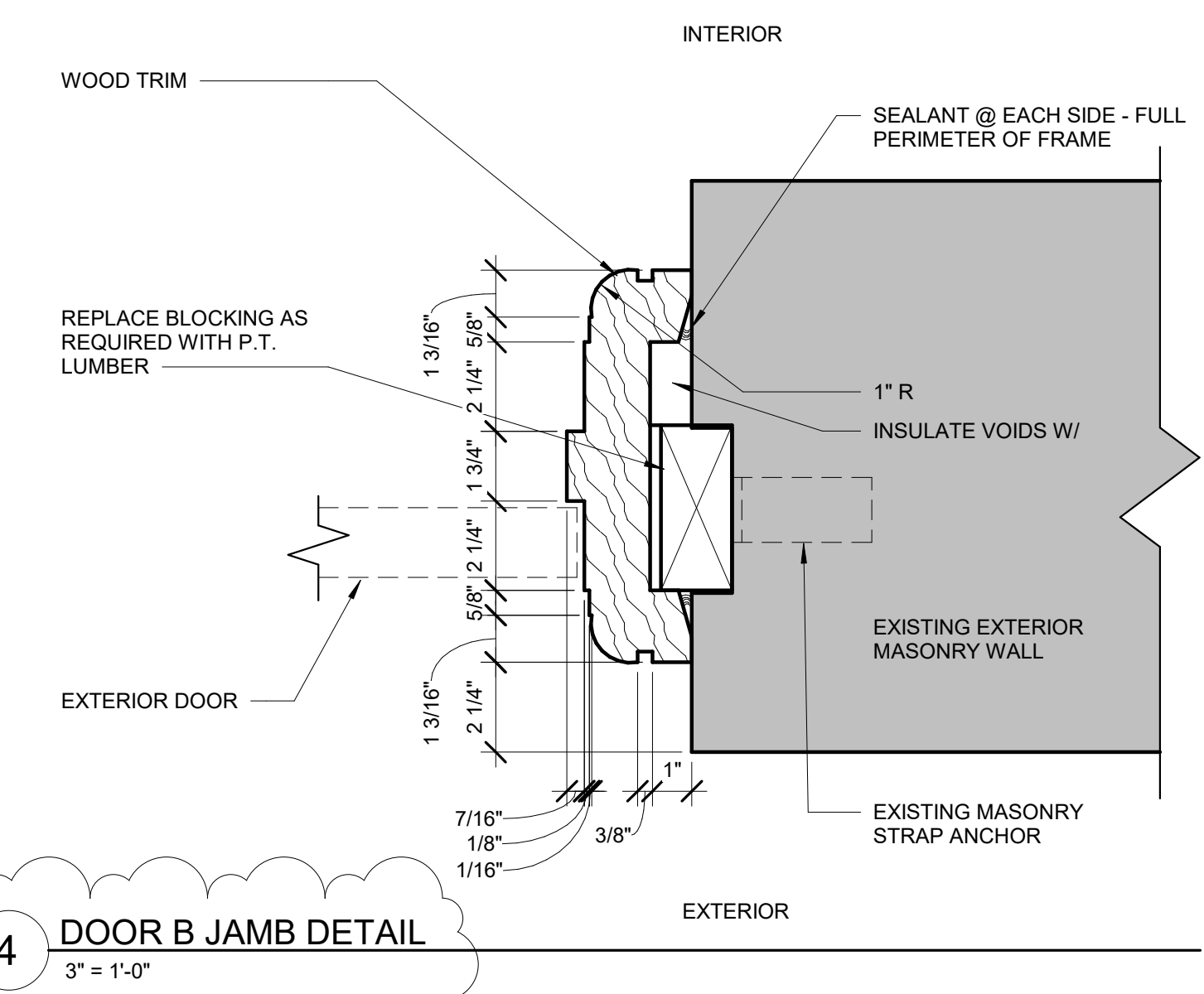

Central File: V:\Projects\NY\K5181785_000\CADD_REV\1115_ELEC_38"x34" PL OF SHEET Saved: 7/20/2020 5:16:18 PM Local File: C:\Users\mferrell\Documents\Peekskill\Toler from Rino Central_M\Framing.rvt



WARNING:

THE ALTERATION OF THIS MATERIAL IN ANY WAY, UNLESS DONE UNDER THE DIRECTION OF A COMPARABLE PROFESSIONAL, I.E. ARCHITECT FOR AN ARCHITECT, ENGINEER FOR AN ENGINEER OR LANDSCAPE ARCHITECT FOR A LANDSCAPE ARCHITECT, IS A VIOLATION OF THE NEW YORK STATE EDUCATION LAW AND/OR REGULATIONS AND IS A CLASS 'A' MISDEMEANOR.

CONSTRUCTION

TITLE: REHABILITATE RESTROOMS

LOCATION: STATE ARMOY
955 WASHINGTON ST.
PEEKSKILL, NY

CLIENT: DIVISION OF MILITARY AND NAVAL AFFAIRS

2	7/29/2020	BID ADDENDUM #2
1	7/20/2020	BID ADDENDUM #1
MARK	DATE	DESCRIPTION
PROJECT NUMBER: 46226-C		
DESIGNED BY: MJF		
DRAWN BY: KKS		
FIELD CHECK BY: MJF		
APPROVED BY: MJF		
SHEET TITLE:		

FINISH PLAN

DRAWING NUMBER: ID-101

ROOM FINISH SCHEDULE

NAME	NUMBER	FLOOR		WALL BASE		WALLS								CEILING		REMARKS
		MATERIAL	FINISH	MATERIAL	FINISH	NORTH		EAST		SOUTH		WEST		MATERIAL	FINISH	
						MATERIAL	FINISH	MATERIAL	FINISH	MATERIAL	FINISH	MATERIAL	FINISH			
DRILL HALL	02	WD	-	-	-	NIC	-	NIC	-	NIC	-	NIC	-	NIC	-	
SUPERINTENDENT OFFICE	4	CPT-1	-	-	-	-	-	-	-	-	-	-	-	-	-	
CLOSET	4A	CPT-1	-	-	-	-	-	-	-	-	-	-	-	-	-	
MEN	05	CT-1	-	WT-1	-	WT-1/PT-1	-	WT-1/PT-1	-	WT-1/PT-1	-	WT-1/PT-1	-	ACT	-	
ADMIN OFFICE	07	CPT-1	-	RB-1	-	EXIST	PT-1	EXIST	PT-1	EXIST	PT-1	EXIST	PT-1	EXIST	-	
BREAK ROOM	8	CPT-1	-	RB-1	-	-	-	-	-	-	-	-	-	-	-	
FIRST FLOOR HALL	10	LT	-	-	-	EXIST	PT-1	EXIST	PT-1	EXIST	PT-1	EXIST	PT-1	-	PT-1	
JAN. CLOSET	10A	LT	-	-	-	EXIST	PT-1	EXIST	PT-1	EXIST	PT-1	EXIST	PT-1	EXIST	-	
CLOSET	10B	LT	-	-	-	EXIST	PT-1	EXIST	PT-1	EXIST	PT-1	EXIST	PT-1	EXIST	-	
MAIN OFFICE	12	CPT-1	-	RB-1	-	-	-	-	-	-	-	-	-	-	-	
OFFICE / STORAGE	13	CPT-1	-	RB-1	-	EXIST	PT-1	EXIST	PT-1	EXIST	PT-1	EXIST	PT-1	EXIST	-	
WOMENS	14	CT-1	-	WT-1	-	WT-1/PT-1	-	WT-1/PT-1	-	WT-1/PT-1	-	WT-1/PT-1	-	ACT	-	
RECRUITING	16	CPT-1	-	RB-1	-	-	-	-	-	-	-	-	-	-	-	

ABBREVIATIONS LEGEND:

WD	WOOD
CPT	CARPET TILE
LT	LINOLIUM TILE
CT	CERAMIC TILE
WT	CERAMIC WALL TILE
RB	RUBBER BASE
PT	PAINT
EXIST	EXISTING

GENERAL LEAD HAZARD NOTES:

- A PORTION OF THE FACILITY INVOLVED WITH THE SCOPE OF WORK FOR THIS PROJECT WAS HISTORICALLY USED AS AN INDOOR FIRING RANGE (IFR). AS A RESULT OF THESE ACTIVITIES, LEAD DUST IS PRESENT WITHIN THE FACILITY. A COMPREHENSIVE SURVEY FOR THE PRESENCE OF LEAD-BASED PAINT HAS BEEN PERFORMED FOR THIS FACILITY. LEAD-CONTAINING PAINT AND LEAD DUST ANTICIPATED TO BE DISTURBED DURING CONSTRUCTION ACTIVITIES SHALL BE ASSUMED TO BE LEAD-BASED PAINT AND LEAD-CONTAMINATED DUST. PERFORM ALL WORK TO MINIMIZE THE MIGRATION OF DUST OR DEBRIS FROM THE PROJECT AREAS TO NON-PROJECT WORK AREAS.
- IN ACCORDANCE WITH OSHA REQUIREMENTS (29 CFR 1926.62) - THE "LEAD IN CONSTRUCTION STANDARD", CONTRACTOR SHALL PROVIDE DOCUMENTATION OF COMPLIANT WORKER EXPOSURE ASSESSMENT PRIOR TO INITIATION OF WORK AND/OR PROVIDE APPROPRIATE PROTECTION FOR PERSONS LIKELY TO COME IN CONTACT WITH AIRBORNE LEAD DURING CONSTRUCTION/RENOVATION ACTIVITIES.
- BULK SAMPLES OF PAINTED OR UNPAINTED SURFACES AS WELL AS THOSE THAT MAY BE CONTAMINATED WITH LEAD DUST HAVE NOT BEEN ANALYZED FOR TOXICITY CHARACTERISTIC LEACHING POTENTIAL (TCLP) ANALYSIS TO DETERMINE WHETHER THE WASTES GENERATED DURING DEMOLITION ARE CLASSIFIED AS NON-HAZARDOUS SOLID OR HAZARDOUS WASTE, AS DEFINED UNDER THE RESOURCE CONSERVATION AND RECOVERY ACT (RCRA). CHARACTERIZE AND DISPOSE OF WASTE IN ACCORDANCE WITH LOCAL, STATE AND FEDERAL REGULATIONS, INCLUDING BUT NOT LIMITED TO RCRA AND 6NYCRR.

FINISH PLAN GENERAL NOTES:

- SCRAPE AND CLEAN EXISTING PAINT FROM WALLS AND CEILING IN CORRIDOR. PREPARE SURFACES FOR NEW PAINT.

FINISH PLAN KEYNOTES:

- EXISTING STONE BORDER AND WALL BASE TO REMAIN

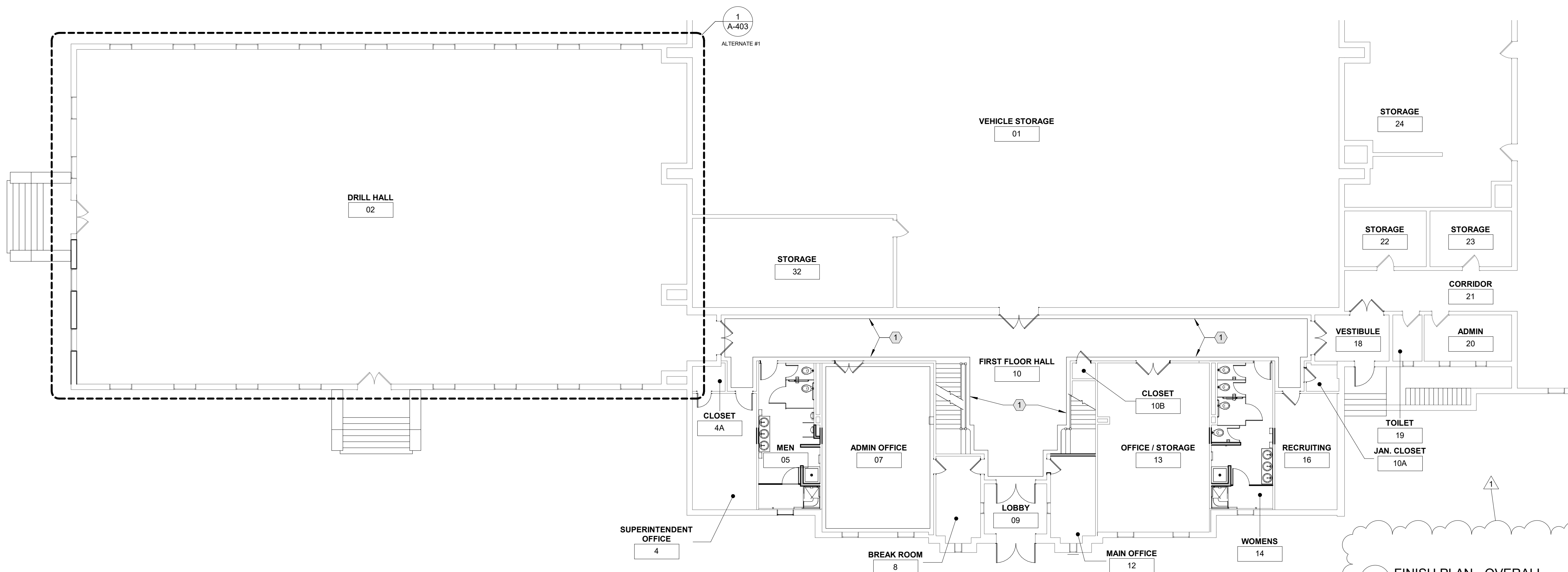

1 FINISH PLAN - OVERALL
3/32" = 1'-0"

Central File: V:\Projects\NYK501785-000\CADD-REV\115 ELEC 3/24/20 PL OF SHEET Saved: 7/20/2020 10:26:01 AM Local File: B:\Buildings\AR1919\07_00_NY5003 Army Lead Remediation\AR1919_07_10_Peekskill Army Lead Remediation\AR1919_07_10_Peekskill Army Lead Remediation\Peekskill Toilet Room Restroom Contral.rvt